

*DAMAC*



VOLTA

SHEIKH ZAYED ROAD, DUBAI

OB  
O  
B  
E  
T  
T  
E  
R  
B  
E  
T  
T  
E  
R  
B  
E  
T  
T  
E  
R

B  
E  
T  
T  
E  
R  
B  
E  
T  
T  
E  
R

B  
E  
T  
T  
E  
R  
B  
E  
T  
T  
E  
R

L  
I  
V  
E  
B  
E  
T  
T  
E  
R  
B  
E  
T  
T  
E  
R





PUSH THE  
LIMITS OF LUXURY,  
OF EVERYTHING  
YOU THOUGHT  
POSSIBLE,  
EVERY DAY,  
IN EVERY WAY.

ELEVATE  
YOUR

STATUS

ENGINEERED  
FOR EVOLUTION



VOLTA

SHEIKH ZAYED ROAD, DUBAI





V

FEEL THE  
BEAT OF LIFE.

Volta is a one-of-a-kind, 60-storey residential tower inspired by the powerful human desire to reach beyond what is expected and live a life where excellence is ordinary. The dynamically-designed skyscraper has curated environments for fitness, wellness and wellbeing alike. With amenities split between the semi-detached podium, roof and even the lobby, residents are never far from something to do...or somewhere to do nothing.



# HIGHWAY TO

# THE TURRET



Volta is enviably situated on Sheikh Zayed Road, Dubai's main artery. The road is emblematic of the city's incredible progress and is home to the world's tallest three hotels, residential towers, offices, restaurants and more. Those staying here have quick and easy access to Downtown Dubai, while destinations such as Dubai Marina and Palm Jumeirah are just minutes away, along with Dubai International Airport (under 15 minutes).

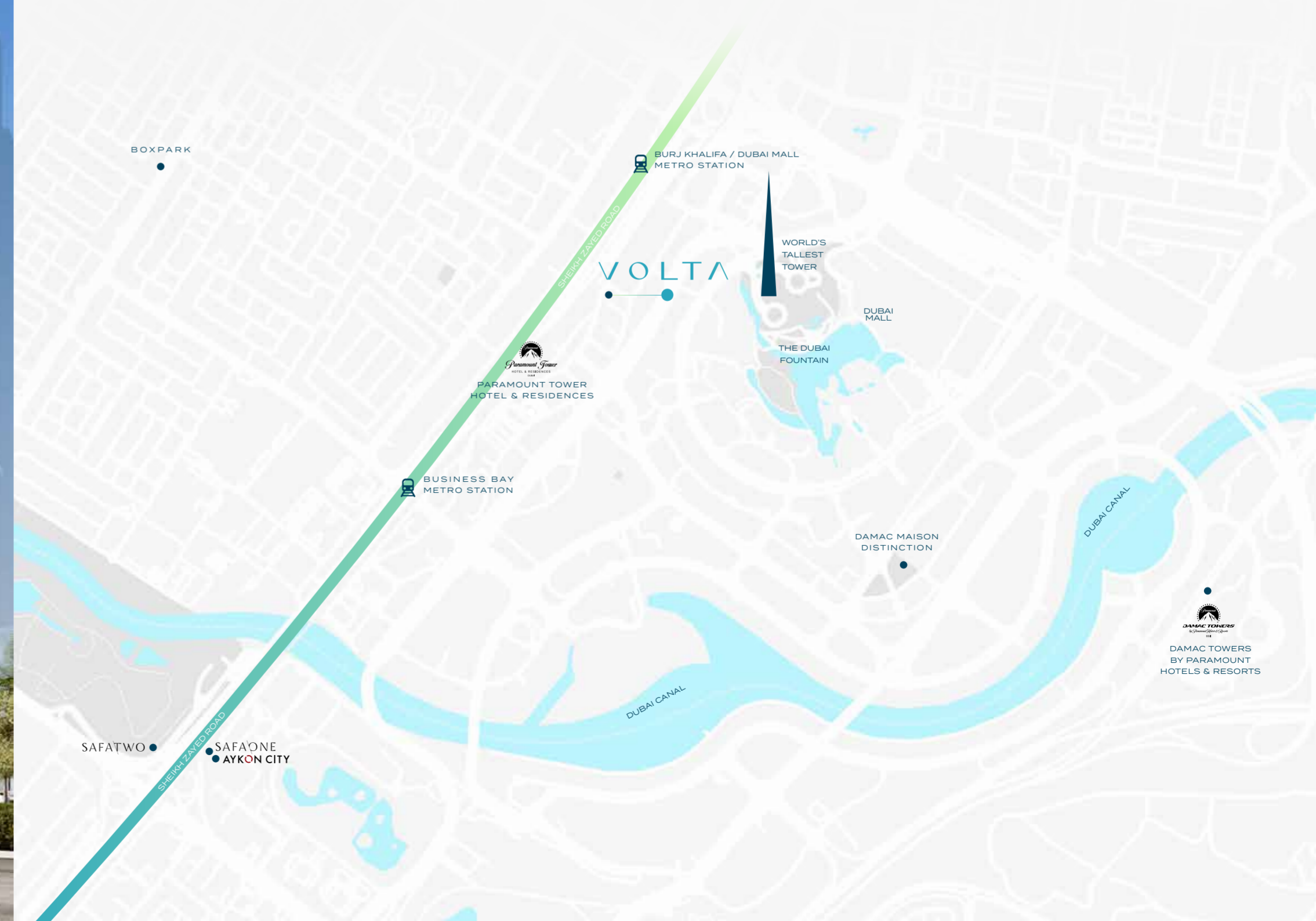



FOR  
MOTIVATION,  
JUST LOOK  
OUTSIDE.

Residents enjoy uninterrupted views of the city skyline. The world-famous Burj Khalifa and glorious Dubai skyscape will inspire you from your wrap around balcony or the tower's outdoor amenities.





# FOR THE FRONTLINE TIME FROM A DIFFERENT VIEW

The philosophy of making the most of life extends to Volta's physical spaces as well. Enter the lobby and take on the climbing wall for a quick adrenaline rush before seeing what the evening brings. Don't forget to stop to see if you've made the dynamic, 'biggest movers' board, celebrating those who've clocked the most activity on their smartwatch!



# CHAMPIONS KEEP PLAYING UNTIL THEY GET RIGHT

BILLIE JEAN KING

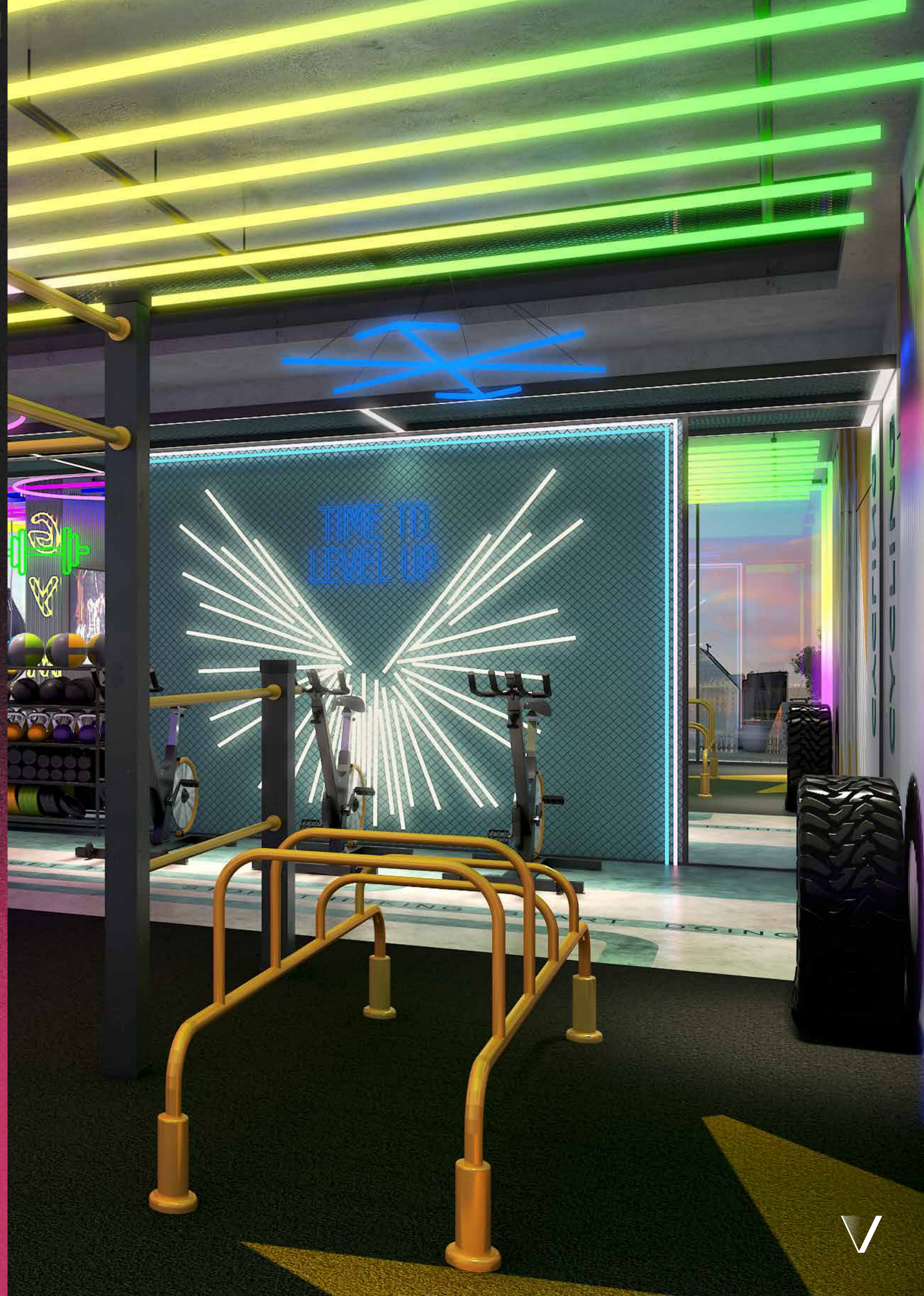



CYCLING

NO DAY OFF

DON'T SIT GET FIT

NO GAIN

PUSH THROUGH THE PAIN

20 INCH



WELLSTAYS  
THIS IS OUR  
LIFE  
DAILY  
R  
E  
O  
R  
D



LIVE IN AN ARENA  
OF ADRENALINE-  
FUELLED AMENITIES.



Take a few laps in the swimming pool, attend an aqua gym class, burn and build with some outdoor calisthenics or hit the jogging track that will also take you right into the main tower.



# THESE DAYS OFFER A NEW CONCEPT

In the crown of Volta lies an oasis of spaces to inspire you to take things slow and recharge. Centre yourself with sky yoga or simply cool off after a workout while taking in impressive views of the skyline.



# EQUIPPED FOR LIFE

Support is never far away at Volta. The tower has its own on-site emergency room, as well a diet consultant and physiotherapist. Additionally, the spa offers not just beauty treatments, but aqua massages and spa therapy.









# SMITHS SWEET FITNESS FOR YOU

TAKE FITNESS TO  
A NEW LEVEL WITH  
EVERY WORKOUT.



Explore new sides of yourself in the multisensory yoga room, challenge yourself with TRX or give in to your most energetic, competitive desires in the 24/7 boxing ring.

# IT IS NOT THE MOUNTAIN WE CONQUER BUT OURSELVES

SIR EDMUND HILLARY



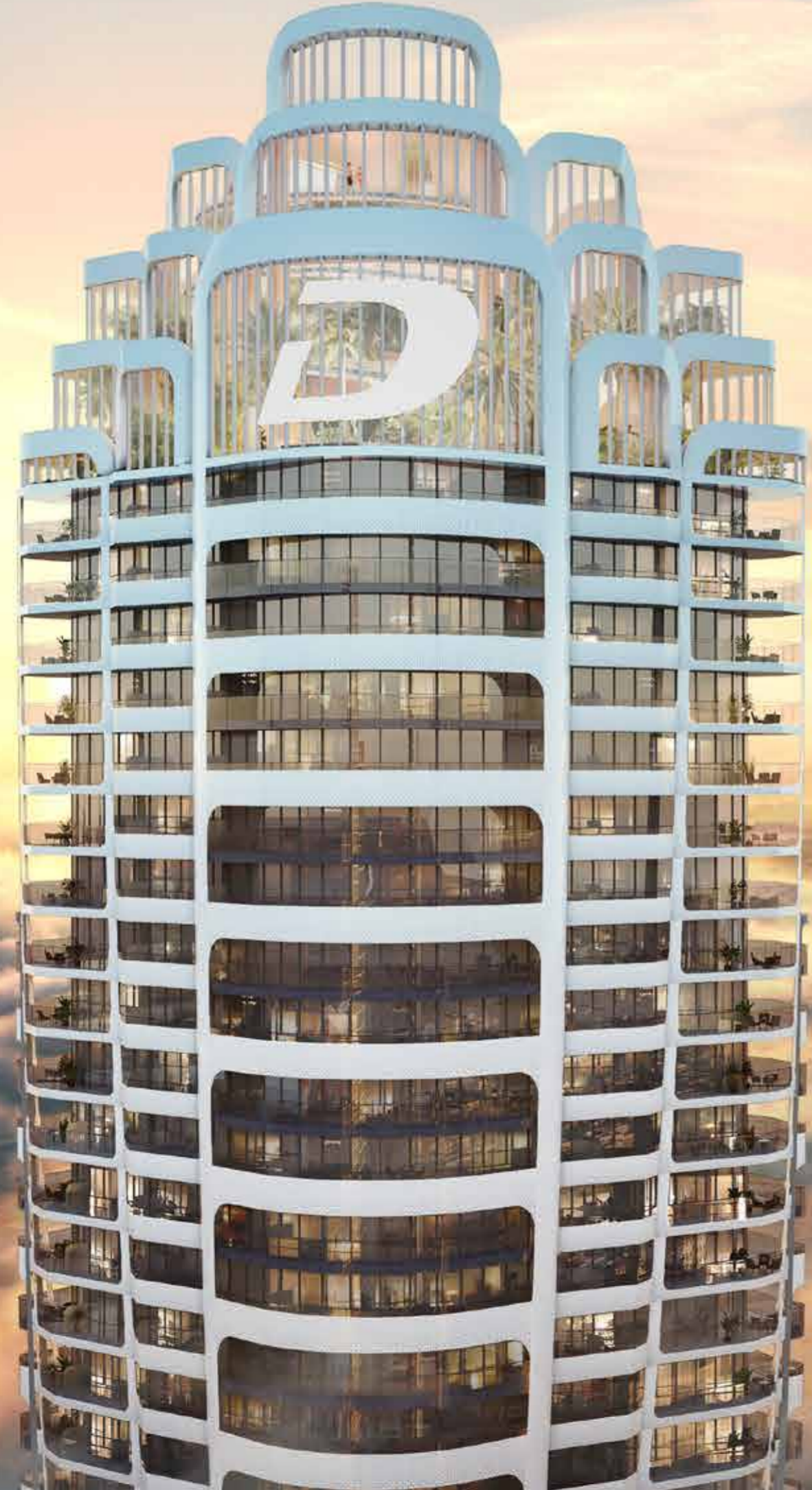

# RIQUNE PEEAK BYOUR PEEAK





WELCOME TO  
TOP-OF-THE-  
LEADERBOARD  
LIVING.

The one and two luxury apartments are situated on levels two to 50, while those seeking the ultra-luxury three and four bedroom residences are catered to on levels 51 to 60. However, whichever you choose, you are guaranteed the very best living experience.





SOVAT

145 322

100%

1 2 3 4 5 6 7 8 9 10

1 2 3 4 5 6 7 8 9 10

1 2 3 4 5 6 7 8 9 10







Champions keep playing until they get it right.  
Billie Jean King







I BELIEVE  
IN THE  
IMPOSSIBLE  
BECAUSE  
I KNOW  
DOES

FLORENCE GRIFFITH JOYNER



VOLTA  
SHEIKH ZAYED ROAD, DUBAI

LUXURY  
FLOOR PLANS

# 1-BEDROOM LUXURY

TYPE A1, A2



# 1-BEDROOM LUXURY

TYPE A1-M



LEVELS: 2-7



LEVEL: 8



LEVEL: 11

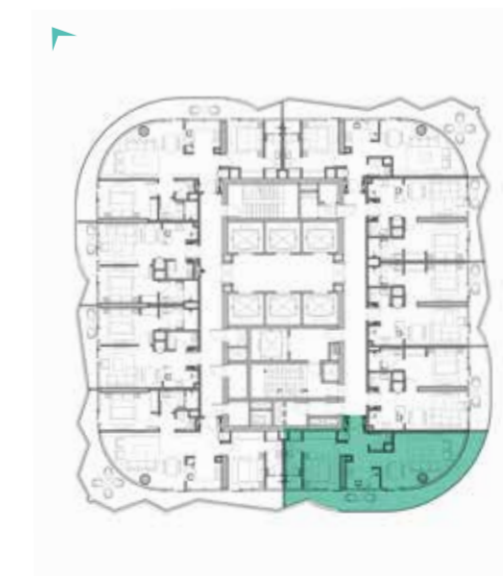

LEVELS: 2-7



LEVEL: 8

# 1-BEDROOM LUXURY

TYPE B1

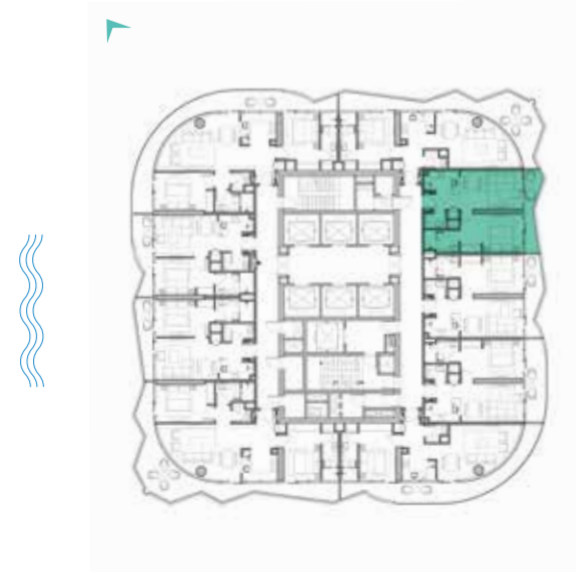

LEVELS: 2-7

# 1-BEDROOM LUXURY

TYPE B1M

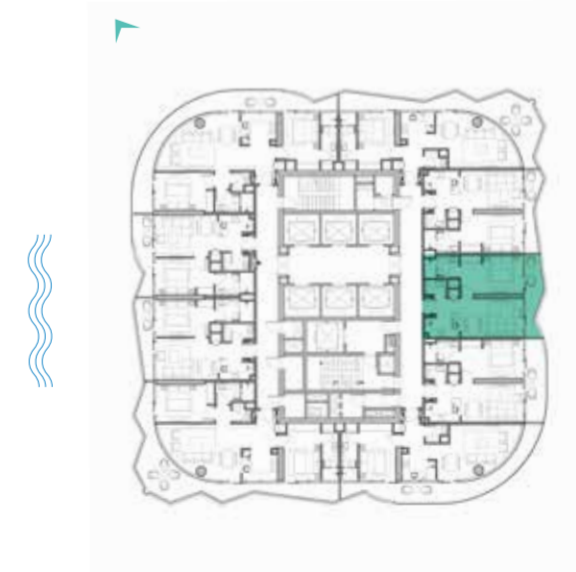

LEVELS: 2-7

# 1-BEDROOM LUXURY

TYPE B2-M

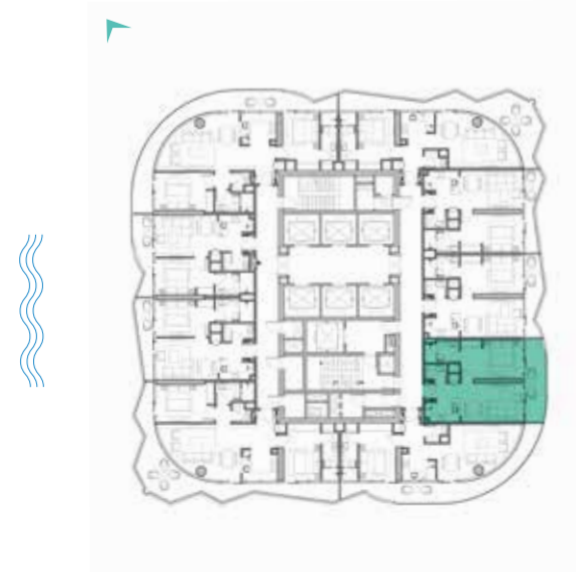

LEVELS: 2-7

# 1-BEDROOM LUXURY

TYPE B3M-B12M

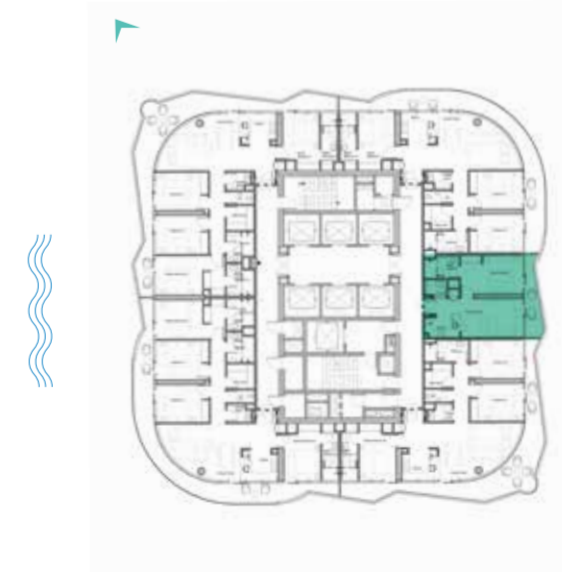

LEVELS: 51-60

# 1-BEDROOM LUXURY

TYPE C1-C10



# 1-BEDROOM LUXURY

TYPE C1M-C10M

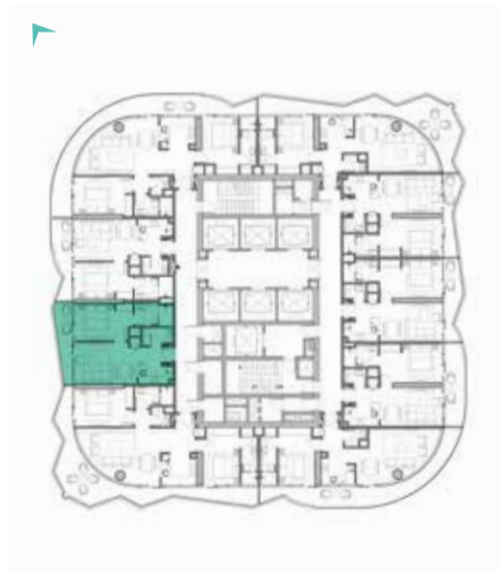

LEVELS: 2-7



LEVEL: 8

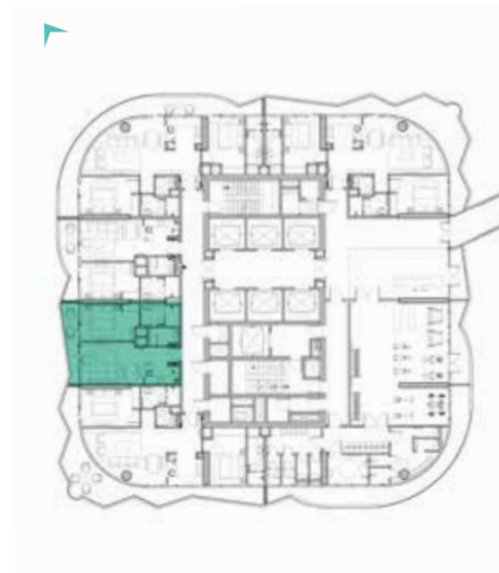

LEVEL: 10

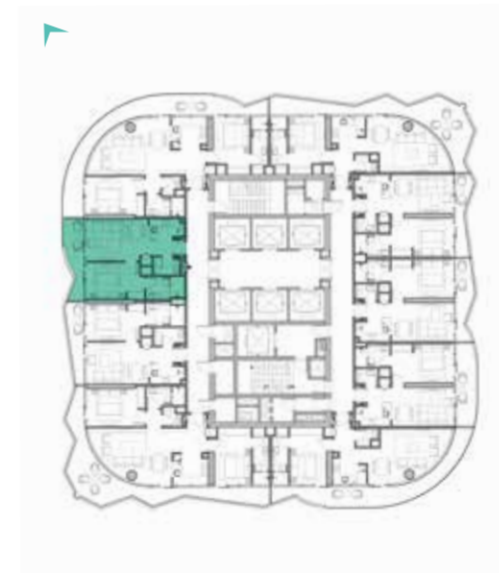

LEVELS: 2-7

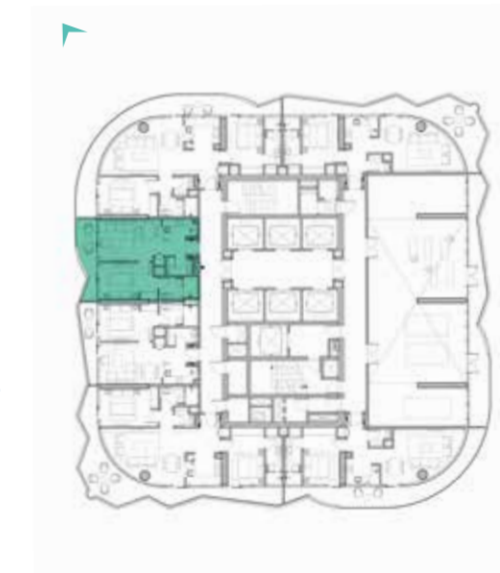

LEVEL: 8



LEVEL: 10



LEVELS: 11

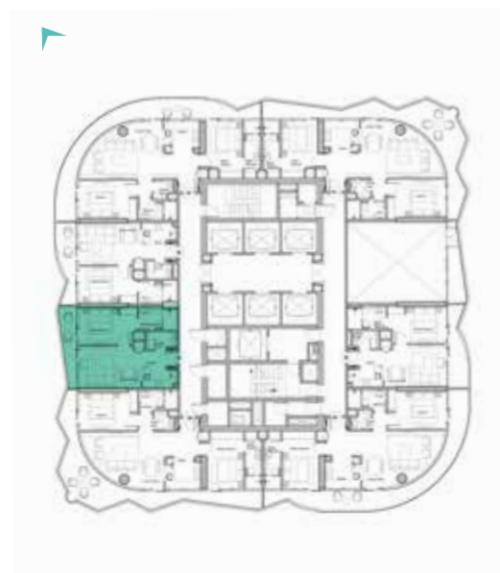

LEVEL: 12

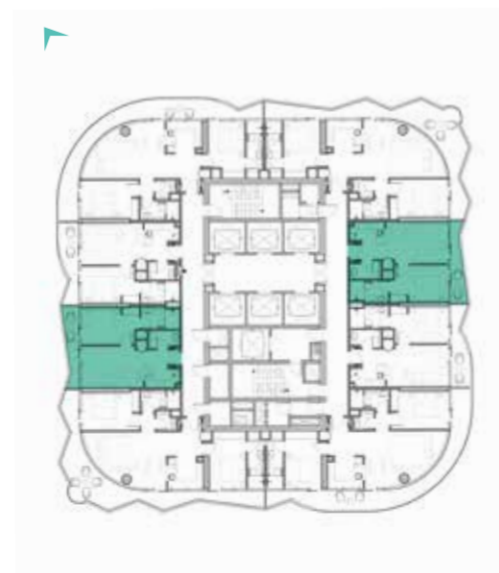

LEVEL: 13-18



LEVELS: 11

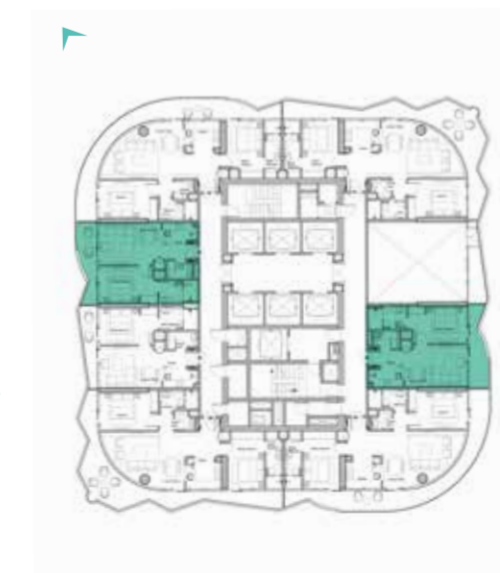

LEVEL: 12

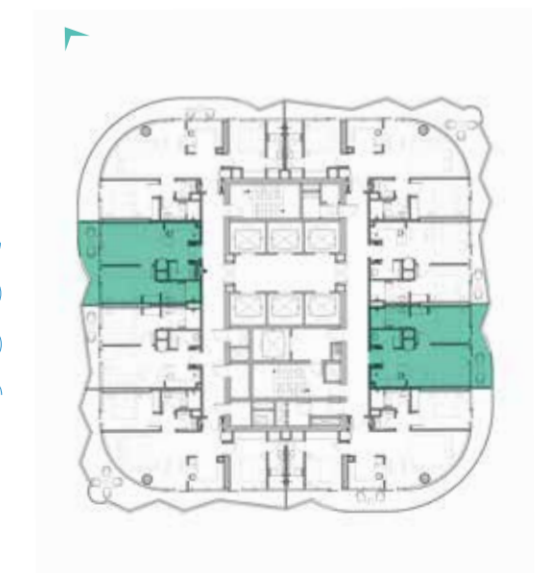

LEVEL: 13-18

# 1-BEDROOM LUXURY

TYPE C11-C20

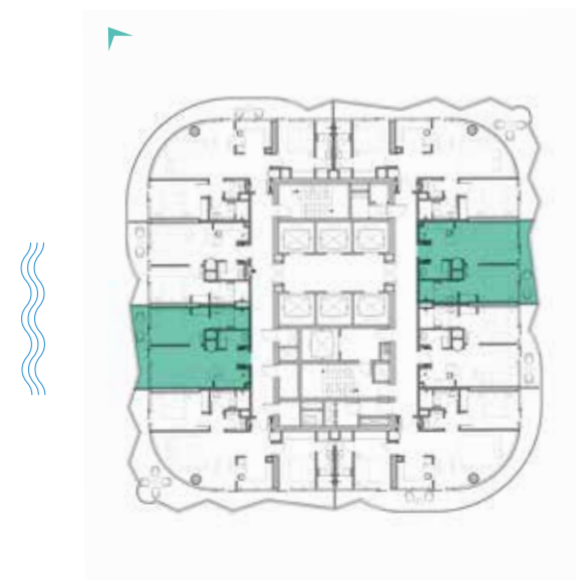

LEVELS: 19-28

# 1-BEDROOM LUXURY

TYPE C11M-C20M

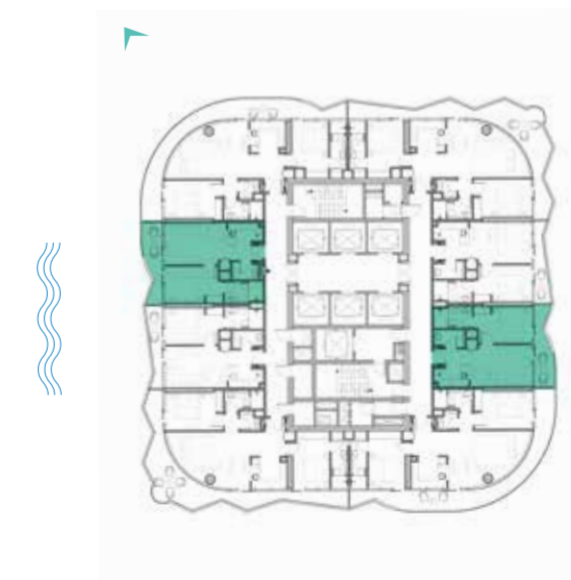

LEVELS: 19-28

# 1-BEDROOM LUXURY

TYPE C21-C30

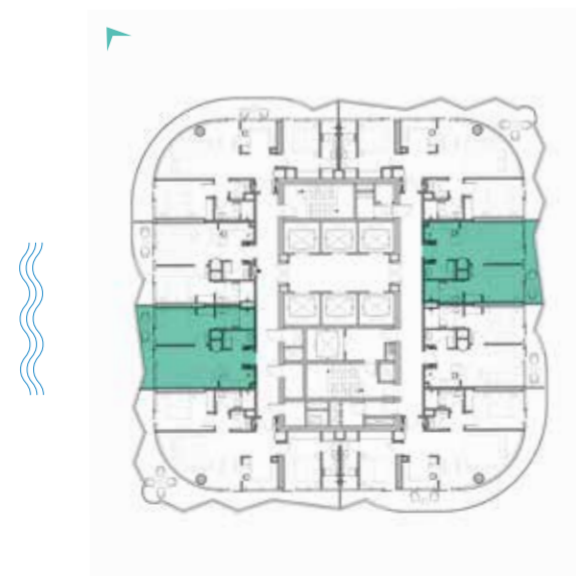

LEVELS: 29-39

# 1-BEDROOM LUXURY

TYPE C21M-C30M

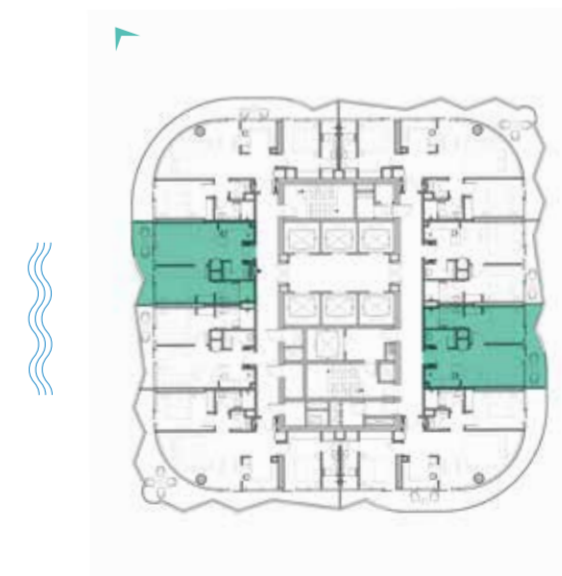

LEVELS: 29-39



# 1-BEDROOM LUXURY

TYPE C31-C41

# 1-BEDROOM LUXURY

TYPE C31M-C41M

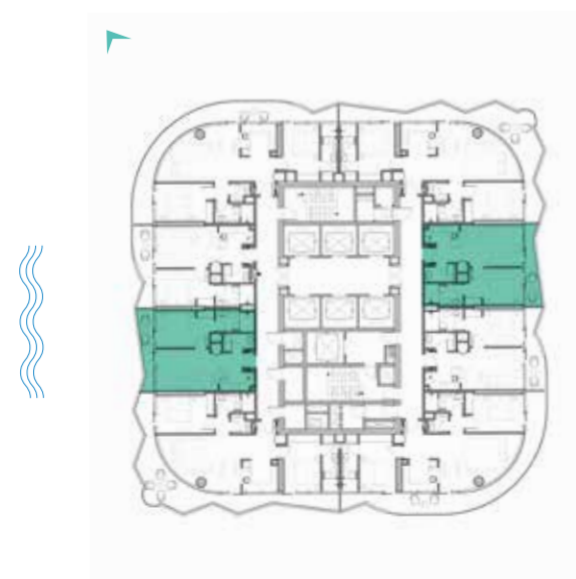

LEVELS: 40-50

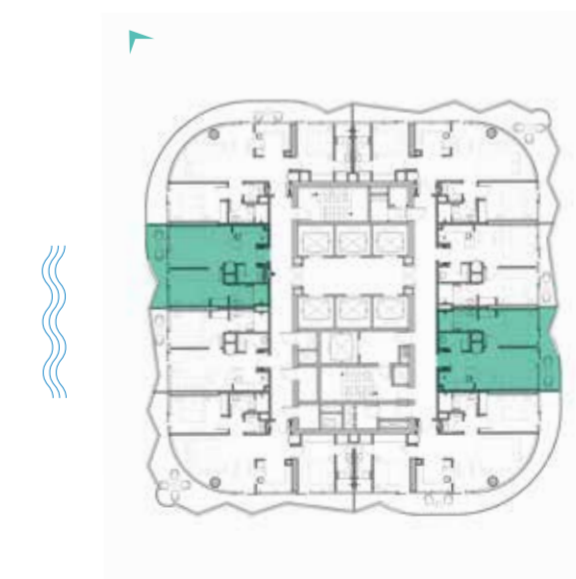

LEVELS: 40-50

# 2-BEDROOM LUXURY

TYPE A1-A10 & A39



# 2-BEDROOM LUXURY

TYPE A1 M-A10 M & A39 M



LEVELS: 2-7



LEVEL: 8



LEVEL: 10



LEVELS: 2-7



LEVEL: 8



LEVEL: 10



LEVELS: 11



LEVEL: 12

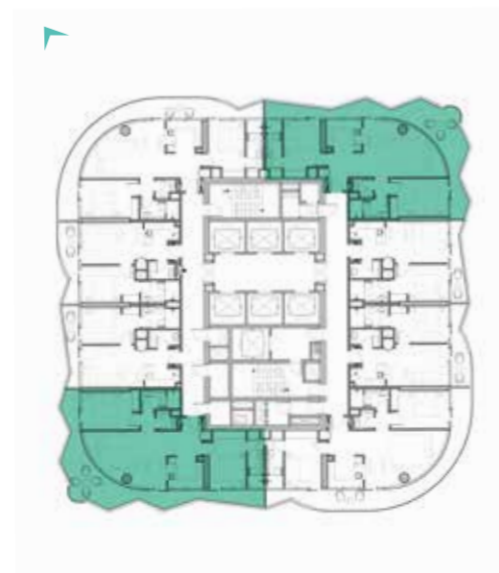

LEVEL: 13-19

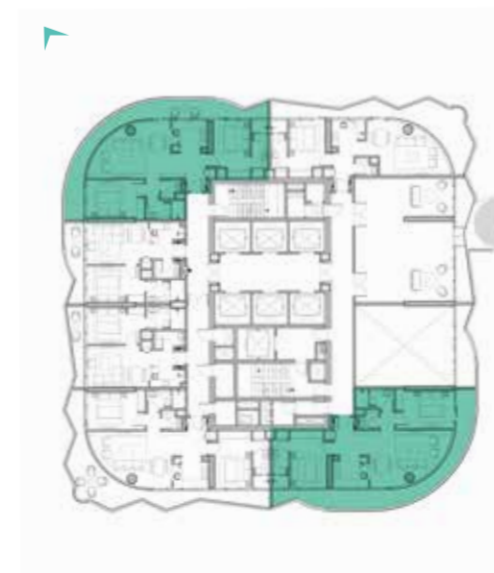

LEVELS: 11



LEVEL: 12

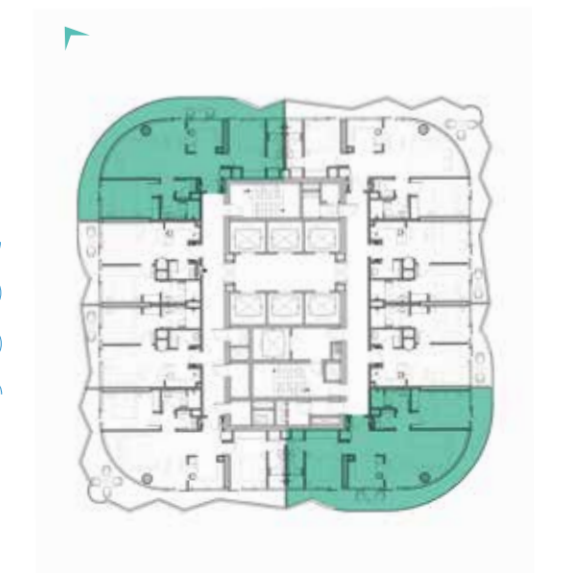

LEVEL: 13-19

# 2-BEDROOM LUXURY

TYPE A11-A20

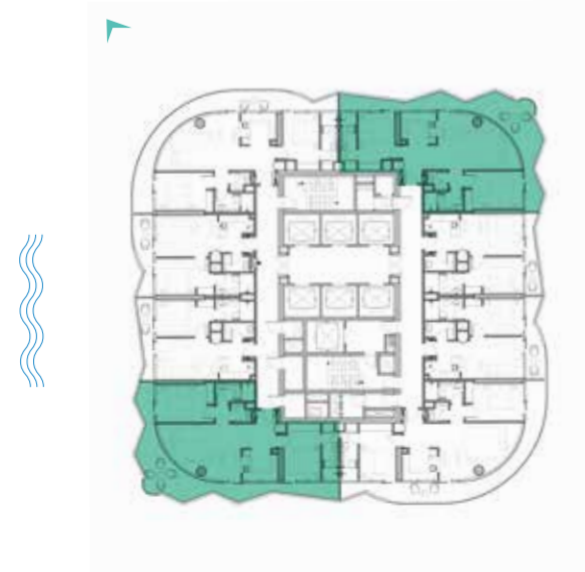

LEVELS: 20-29

# 2-BEDROOM LUXURY

TYPE A11M-A20M

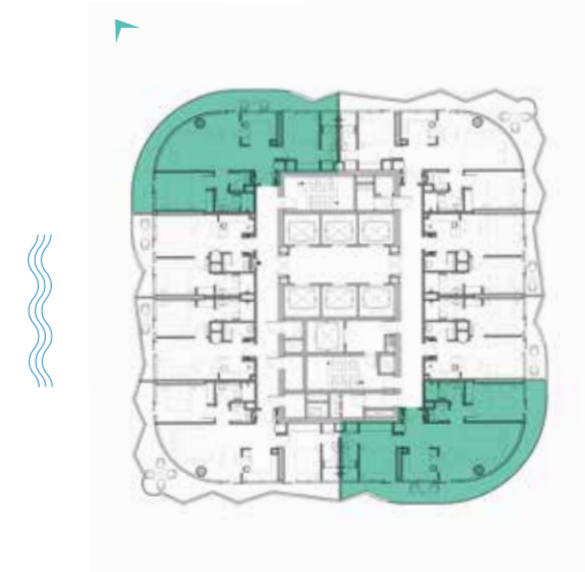

LEVELS: 20-29

# 2-BEDROOM LUXURY

TYPE A21-A30

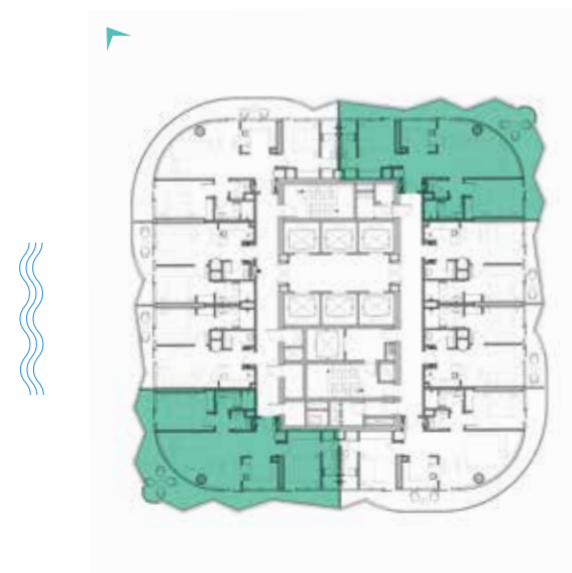

LEVELS: 30-40

# 2-BEDROOM LUXURY

TYPE A21M-A30M

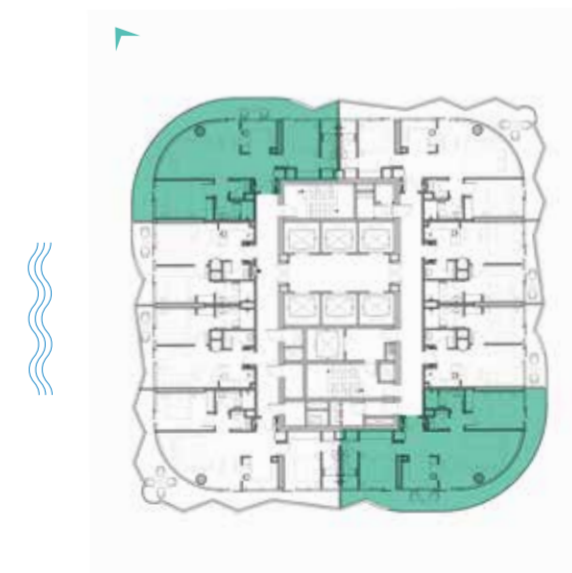

LEVELS: 30-40

# 2-BEDROOM LUXURY

A31-A38, A40 & A41

# 2-BEDROOM LUXURY

TYPE A31 M -A38 M, A40 M & A41 M

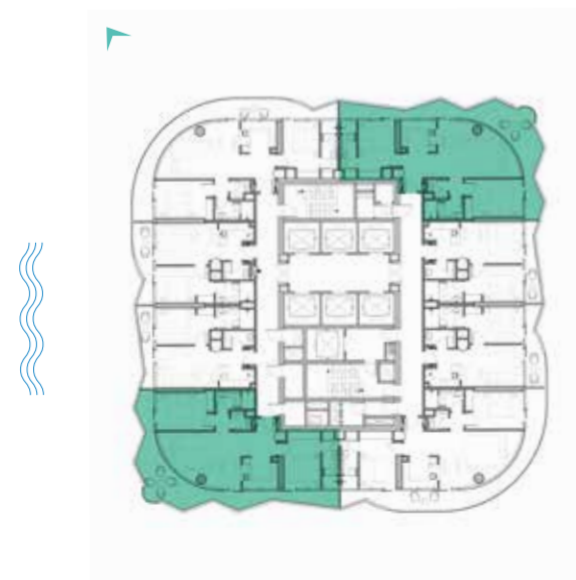

LEVELS 41-50

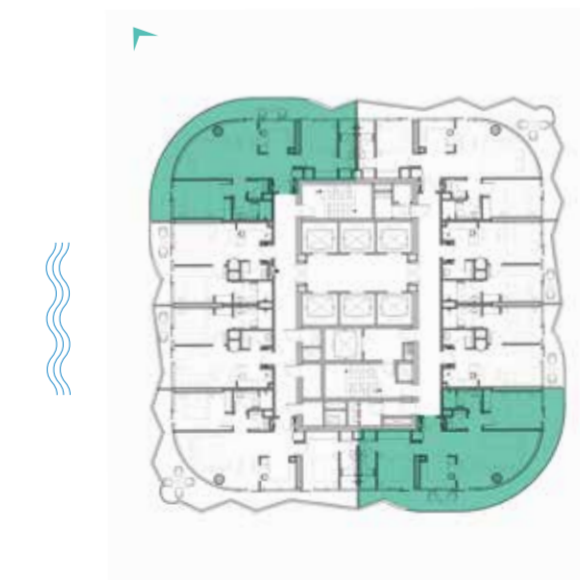

LEVELS 41-50



VOLTA  
SHEIKH ZAYED ROAD, DUBAI

SUPER LUXURY  
FLOOR PLANS

# 3-BEDROOM SUPER LUXURY

TYPE A1-A10

# 3-BEDROOM SUPER LUXURY

TYPE A1M-A10M

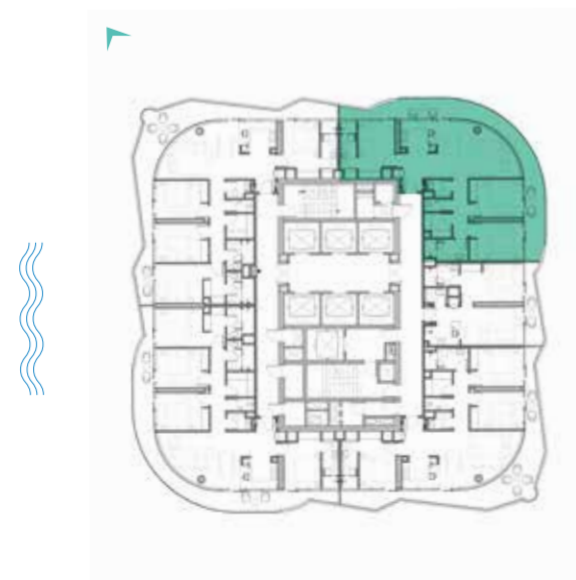

LEVELS 51-60

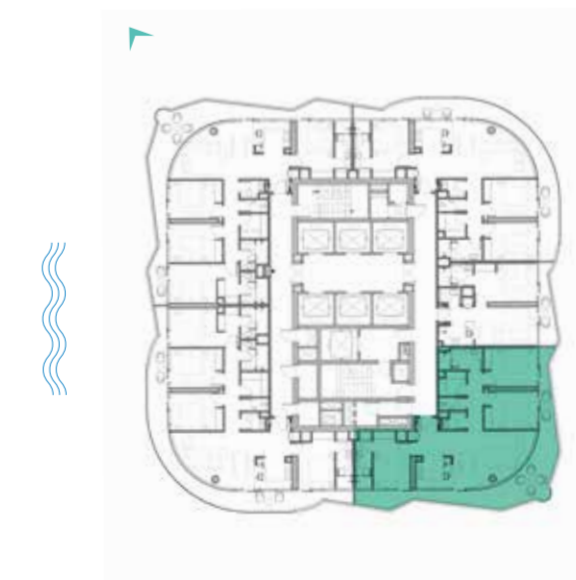

LEVELS 51-60

# 4-BEDROOM SUPER LUXURY

TYPE A1-A10



LEVELS 51-60

# 4-BEDROOM SUPER LUXURY

TYPE A1M-A10M



LEVELS 51-60



# DAMAC PROPERTIES

LIVE THE LUXURY

DAMAC Properties has been at the forefront of the Middle East's luxury real estate market since 2002, delivering award-winning residential, commercial and leisure properties across the region and around the world, including the UAE, Saudi Arabia, Qatar, Jordan, Lebanon, Iraq, Maldives, Canada, the United States, and the United Kingdom. Since then, the company has delivered approximately 46,000 homes, with a development portfolio of more than 33,000 at various stages of planning and progress.\*

Joining forces with some of the world's most eminent fashion and lifestyle brands, DAMAC has brought new and exciting living concepts to the market with collaborations that include a golf course managed by The Trump Organization, and luxury homes in association with Versace, de GRISOGONO, Cavalli, Just Cavalli, Paramount Hotels & Resorts, Rotana and the Radisson Hotel Group. With a consistent vision and strong momentum, DAMAC Properties is building the next generation of Middle Eastern luxury living.

DAMAC places a great emphasis on philanthropy and corporate social responsibility. The Hussain Sajwani – DAMAC Foundation (HSDF), a joint initiative between DAMAC Group and Hussain Sajwani, announced the launch of the 'Fresh Slate' initiative in collaboration with the Dubai Police General Headquarters, aimed at aiding detainees in Dubai's Punitive and Correctional Institutions who have been charged with petty offences.

The HSDF also pledged AED 5 million for the 1 Billion Meals initiative launched by Vice President and Prime Minister of the UAE, and Ruler of Dubai, His Highness Sheikh Mohammed bin Rashid Al Maktoum, at the start of Ramadan 2022, aimed at providing meals to underprivileged communities in 50 countries across the world.

DAMAC has also supported the vision of Sheikh Mohammed to train one million Arab coders in creating an empowered society through learning and skills development, an initiative that successfully wrapped up in May 2022.

\*As of 30th June 2023.

## LUXURY BY APPOINTMENT

CONTACT US AT ANY OF OUR OFFICES OR VISIT [DAMACPROPERTIES.COM](https://damacproperties.com)

### UNITED ARAB EMIRATES

#### Dubai

Tel: 800-DAMAC (800-32622)  
E-mail: [dubai@damacgroup.com](mailto:dubai@damacgroup.com)

Park Towers – Sales Centre  
Dubai International Financial Centre

AYKON City – Sales Centre  
Floor 63, Sheikh Zayed Road

DAMAC Hills – Sales Centre  
Golf Veduta, Townhouse TH2

DAMAC Hills – Sales Centre  
Bellavista (Carson Building)

DAMAC Hills 2 – Sales Centre  
Amazonia Cluster, Villa 333

DAMAC Hills 2 – Sales Centre  
Water Town

### UNITED KINGDOM

DAMAC Tower  
63-71 Bondway London SW8 1SQ  
Tel: +44 (0) 207 590 8050  
[damactower.co.uk](https://damactower.co.uk)

### QATAR

Building 90, New Solta Area  
Ali bin Abi Talib Street  
Next to Omar bin Al Khattab  
Health Centre  
Tel: +974 44 666 986  
Fax: +974 44 554 576  
E-mail: [doha@damacgroup.com](mailto:doha@damacgroup.com)

### KINGDOM OF SAUDI ARABIA

DAMAC Towers Riyadh  
South Tower  
Olaya District  
King Fahd Road  
PO Box 102460  
Tel: +966 11 835 0300  
E-mail: [ksa@damacgroup.com](mailto:ksa@damacgroup.com)

### TURKEY

Levazım, Mah. Koru Sk.  
Zorlu Centre No. 2  
IC Kapi No. 347, Beşiktaş/İstanbul  
Turkey  
Tel: +90 212 892 0327  
Fax: +90 212 890 7184  
E-mail: [turkey.office@damacgroup.com](mailto:turkey.office@damacgroup.com)

### LEBANON

Unit 1801, 18th Floor  
DAMAC Tower  
Omar Daouk Street  
Mina El Hosn, Beirut Central District  
Tel: +961 81 647 200  
E-mail: [beirut@damacgroup.com](mailto:beirut@damacgroup.com)

### JORDAN

Opposite Abdali Mall Gate #1  
Al Istithmar Street  
Abdali Project, Amman  
Tel: +962 6 510 7000  
Fax: +962 6 565 7896  
E-mail: [amman@damacgroup.com](mailto:amman@damacgroup.com)

***DAMAC***